

PROPERTY MAP
TOWN OF
PARKMAN

PISCATAQUIS
COUNTY
MAINE

1979

PREPARED BY
SLF, Inc.
SKOWHEGAN
MAINE

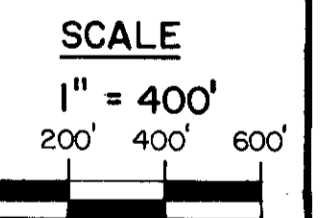

LEGEND
PARCEL NUMBER...5
ADJACENT MAPS...M2
MATCH LINE

NOTE:
FOR ASSESSMENT
PURPOSES ONLY
NOT TO BE USED
FOR CONVEYANCES

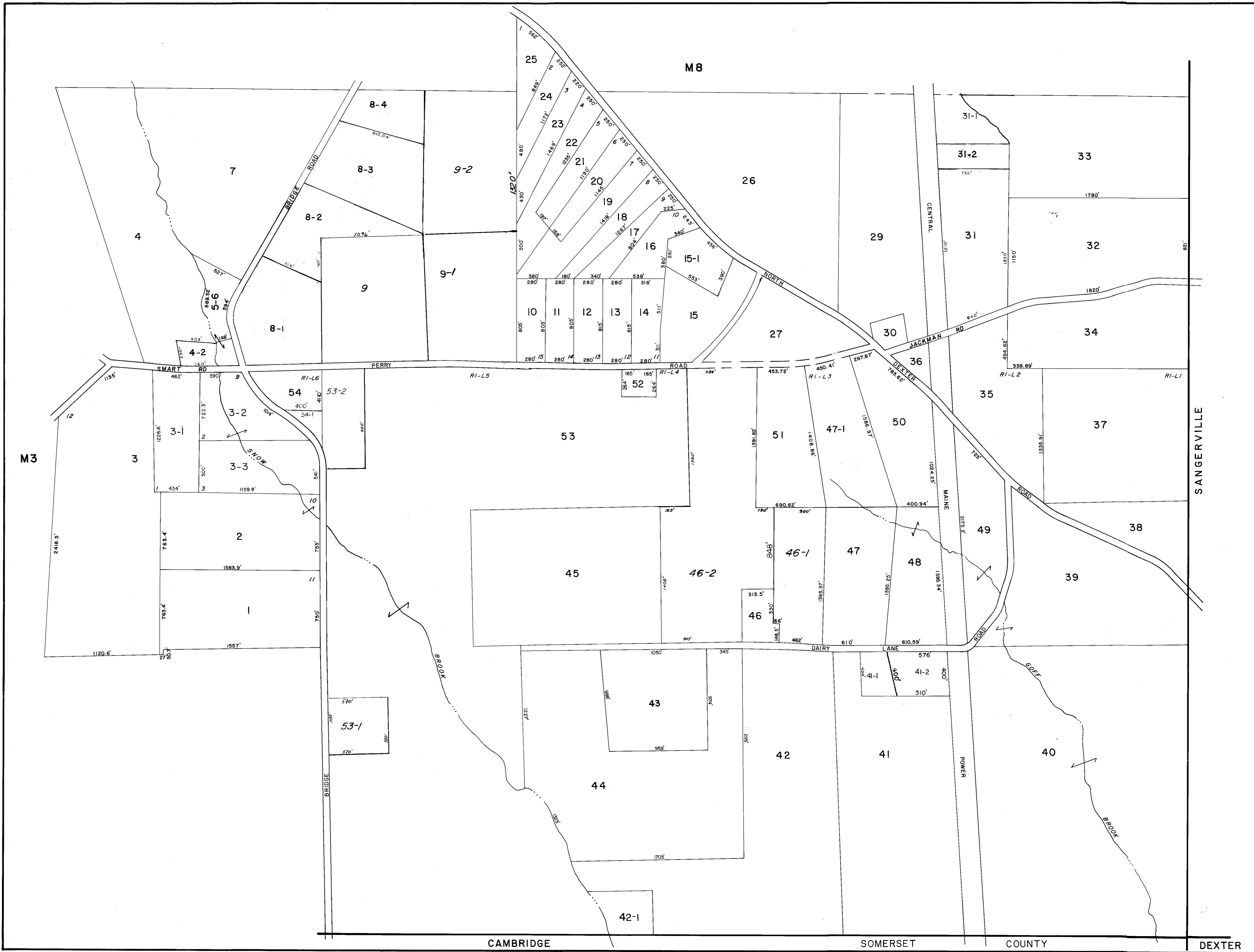

CAMBRIDGE SOMERSET COUNTY DEXTER