

PROPERTY  
MAP  
TOWN  
OF  
PARKMAN

PISCATAQUIS  
COUNTY  
MAINE

1979

PREPARED  
BY  
SLF, Inc.  
SKOWHEGAN  
MAINE

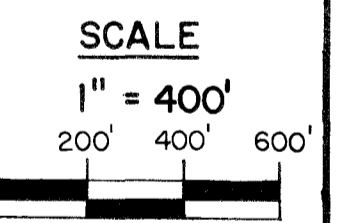

**LEGEND**  
 PARCEL NUMBER... 5  
 ADJACENT MAPS... M2  
 MATCH LINE ---  
 NOTE:  
 FOR ASSESSMENT PURPOSES ONLY  
 NOT TO BE USED FOR CONVEYANCES

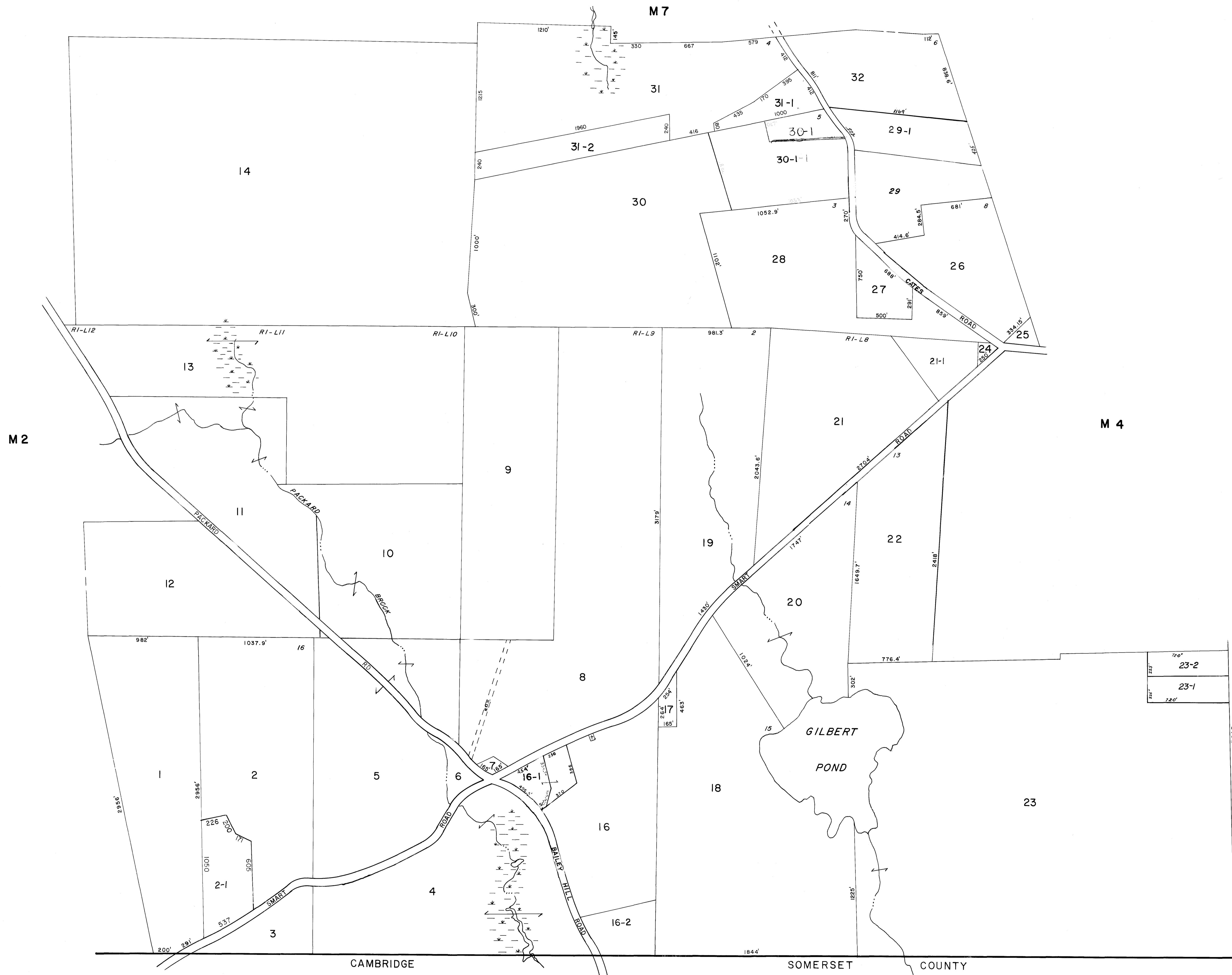

B.L. Mapmaking, P-2011